

CITY HALL STAFF PARKING

WEST 10TH AVENUE

PARK

EAST WING

MAIN BUILDING

CAMBIE STREET

YUKON STREET

WEST 12TH AVENUE

CITY HALL CAMPUS 09.05.06



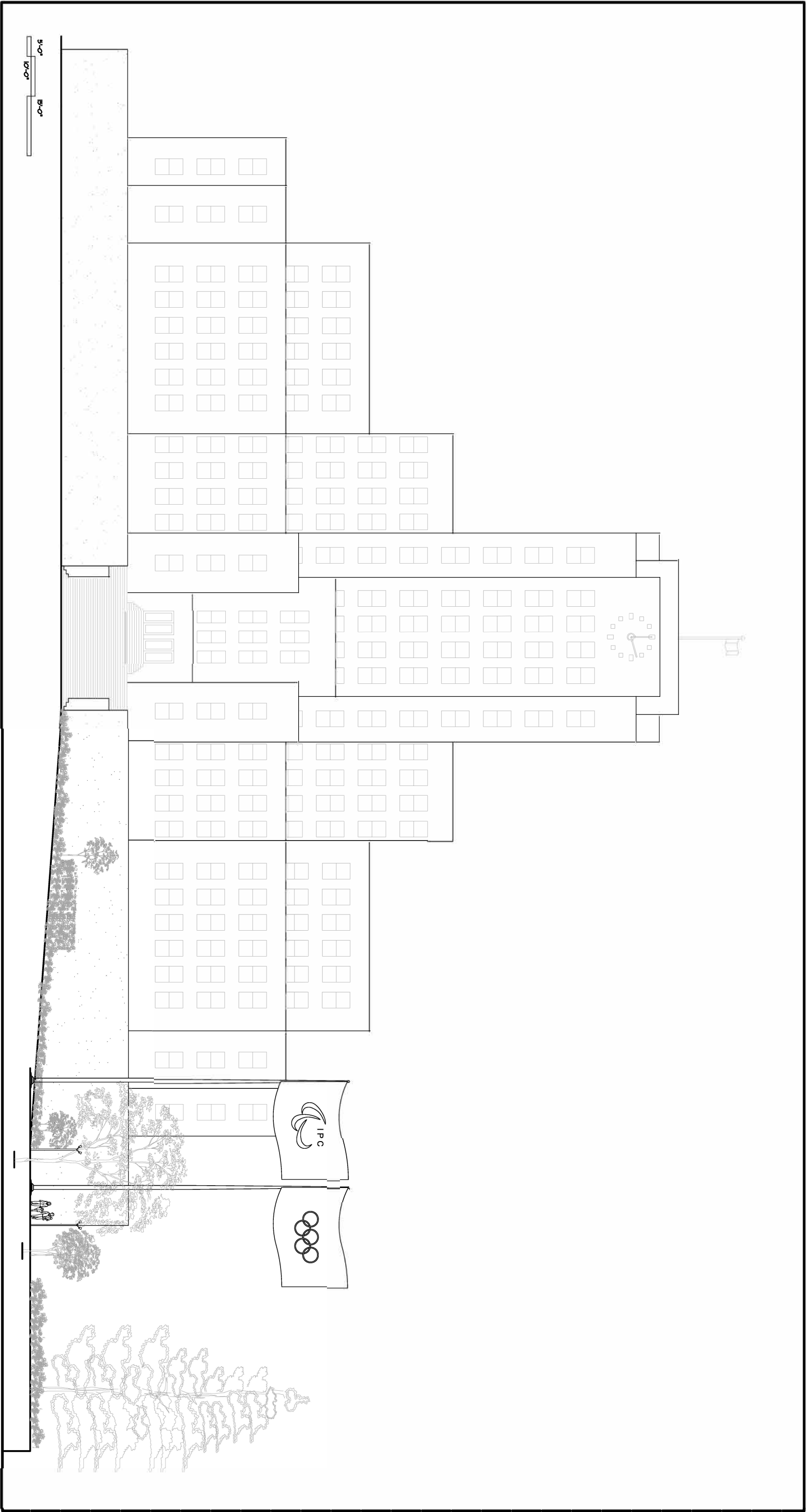

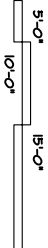
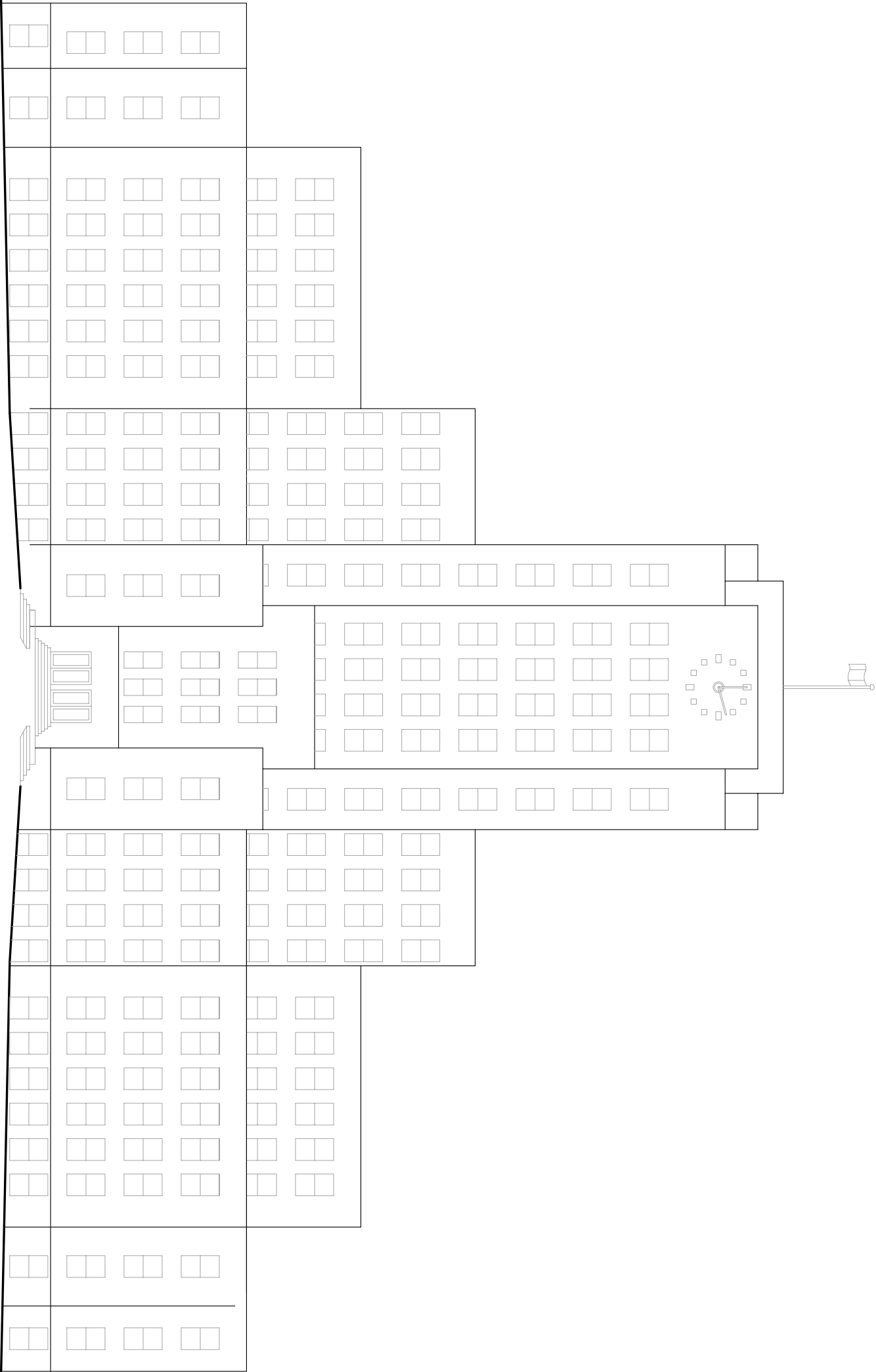

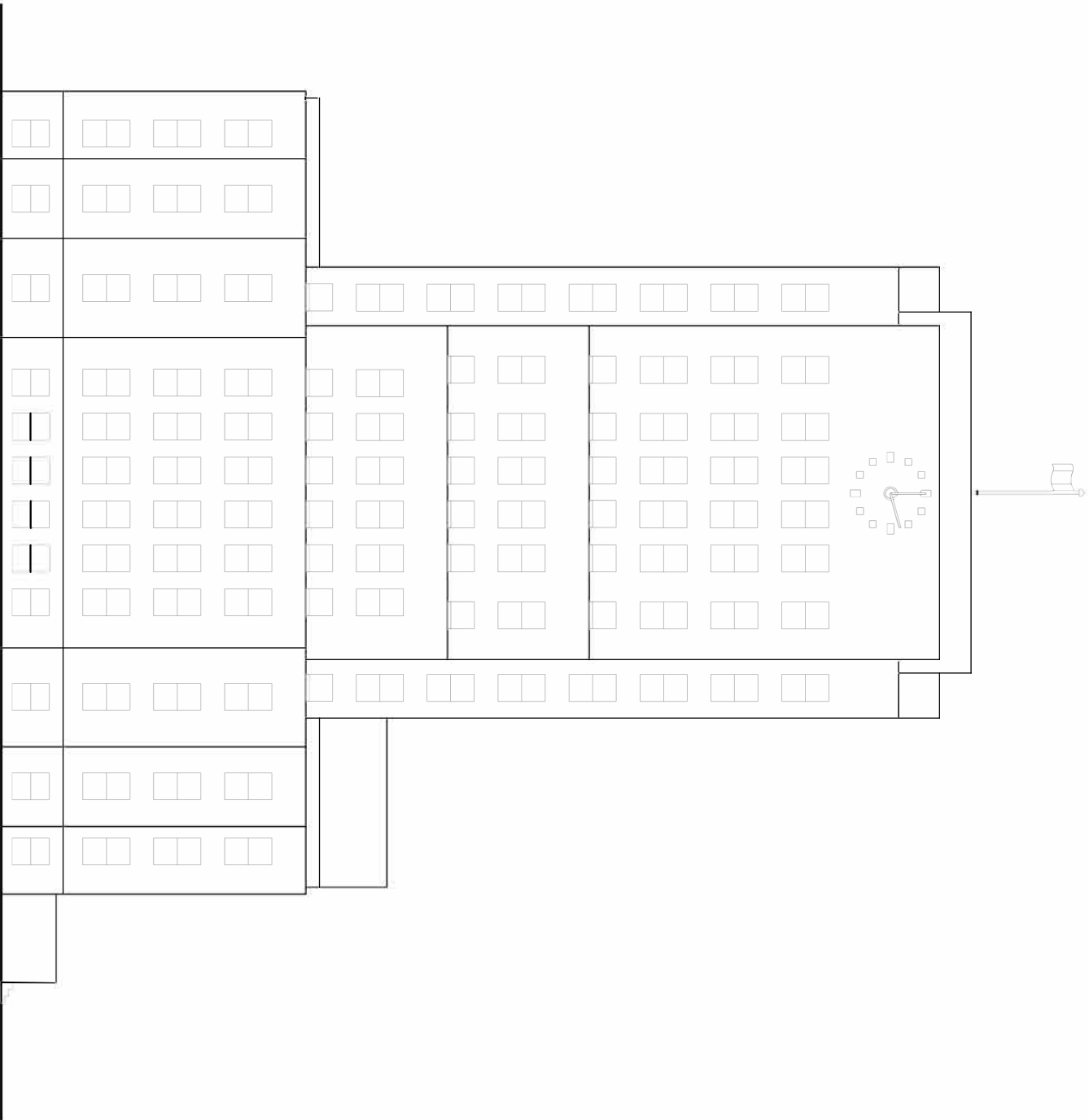

CITY HALL - EAST ELEVATION

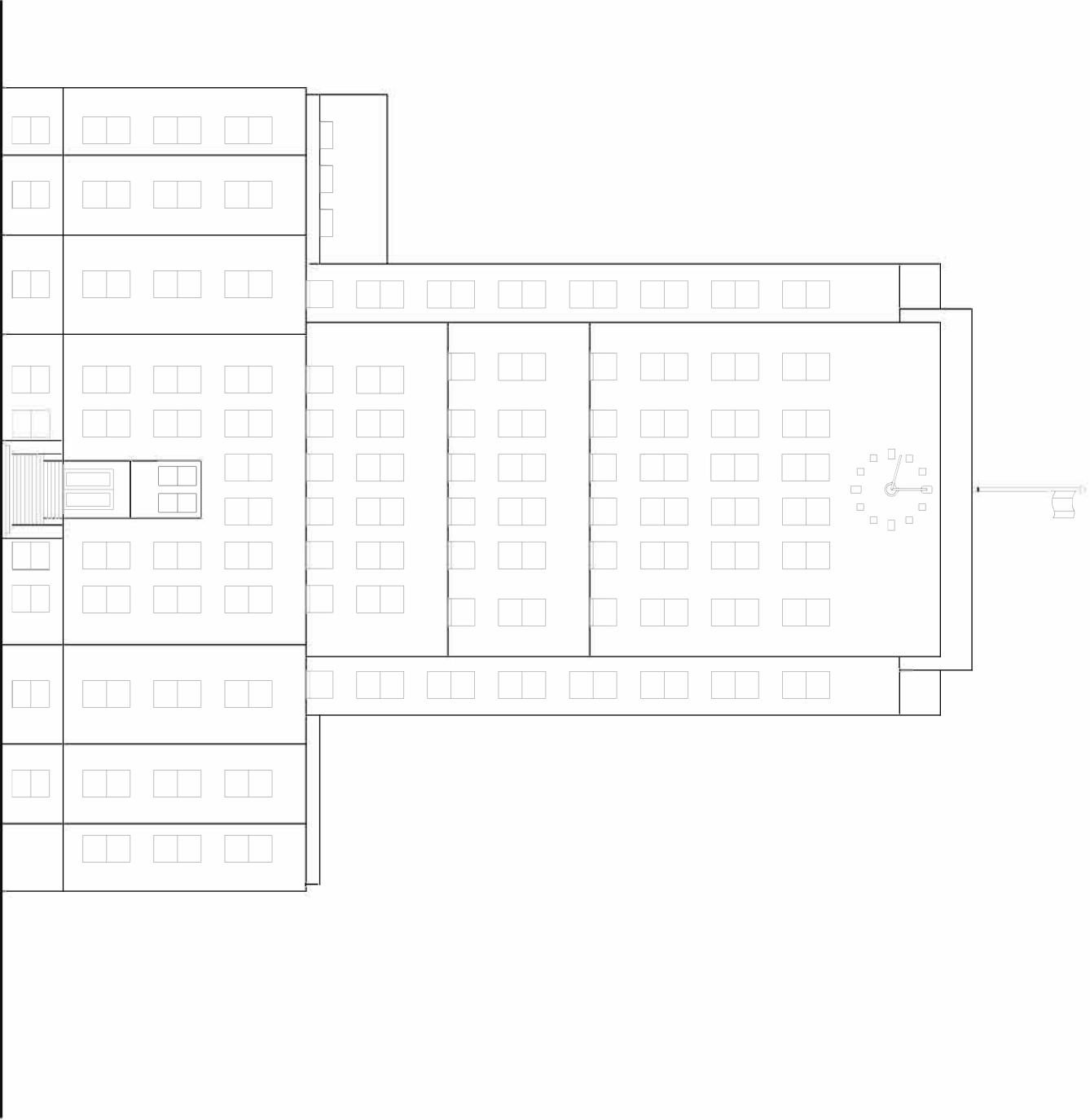
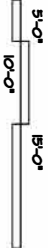

CITY HALL - EAST ELEVATION

1. ALL DIMENSIONS SHOWN ARE APPROXIMATE AND SHALL BE VERIFIED ON SITE.
2. ENGINEER MUST BE NOTIFIED OF ANY DEVIATIONS FROM THESE DRAWINGS.
3. ALL THE ANCHORS SHOWN MEET THE BASIC REQUIREMENTS OF CAN/C.S.A. STANDARD Z91-M90.
4. ALL THE ANCHORS SHOWN MEET THE BASIC REQUIREMENTS OF CAN/C.S.A. STANDARD 2271-98.
5. ALL THE ANCHORS SHOWN MEET THE BASIC REQUIREMENTS OF CAN/C.S.A. STANDARD 2269.2.
6. ALL ANCHORS SHALL BE SECURELY FASTENED TO THE FOLLOWING: REINFORCED CONCRETE WALLS OR SLABS AND/OR STRUCTURAL STEEL.
7. WHERE ANCHORS PENETRATE ROOF FLASHING OR MEMBRANE, ROOFING CONTRACTOR SHALL ENSURE A "WATER-TIGHT" SEAL.
8. SINGLE POINT, PRIMARY SUSPENSION AND/OR SAFETY TIE-BACK ANCHOR AND/OR HORIZONTAL LIFELINE SYSTEM SHALL NOT BE USED TO SUPPORT WORKING LOADS, IN EXCESS OF 1000 lps. or 453.6 kg.
9. THIS SAFETY ANCHORAGE SYSTEM SHALL BE INSPECTED PRIOR TO ITS FIRST SCHEDULED SERVICE AND BEFORE EACH SCHEDULED SERVICE, AND NOT LESS THAN ONCE A YEAR.
10. ON THOSE BUILDINGS WHERE THE PARAPET WALL IS ABSENT, OR LESS THAN 3'-6" IN HEIGHT, ALL WORKERS SHALL BE PROPERLY ATTACHED TO A SAFETY LINE WHICH IS SECURELY FASTENED TO AN "APPROACH" ANCHOR BEFORE APPROACHING THOSE ANCHORS WHICH ARE ADJACENT TO, OR WITHIN 6.5 FEET (2M) OF, THE ROOF EDGE.

GENERAL NOTES

THIS DOCUMENT IS THE PROPERTY OF ATLAS ANCHOR SYSTEMS (B.C.) LTD. AND IN NO PART HEREIN SHALL BE USED, EXCEPT FOR THE SPECIFIC PROJECT, WITHOUT THE WRITTEN CONSENT OF ATLAS ANCHOR SYSTEMS (B.C.) LTD.
THIS DOCUMENT DOES NOT, NEITHER IN WHOLE OR IN PART, CONSTITUTE ANY DIRECTION OR INSTRUCTION TO ANY CONTRACTOR TO PROCEED FROM ANY CONTRACTOR WITH REGARD TO CONSTRUCTION MEANS, METHODS, OR TECHNIQUES.
THIS DOCUMENT DOES NOT CONSTITUTE ANY DIRECTION OR INSTRUCTION TO ANY CONTRACTOR TO PROCEED FROM THE OWNER/CLIENT. THE OWNER/CLIENT EXCLUSIVELY SHALL BE LIABLE FOR ANY PAYMENTS PROPERLY DUE TO ANY CONTRACTOR.

COPYRIGHT ©

ROOF PLAN
SCALE: N.T.S.

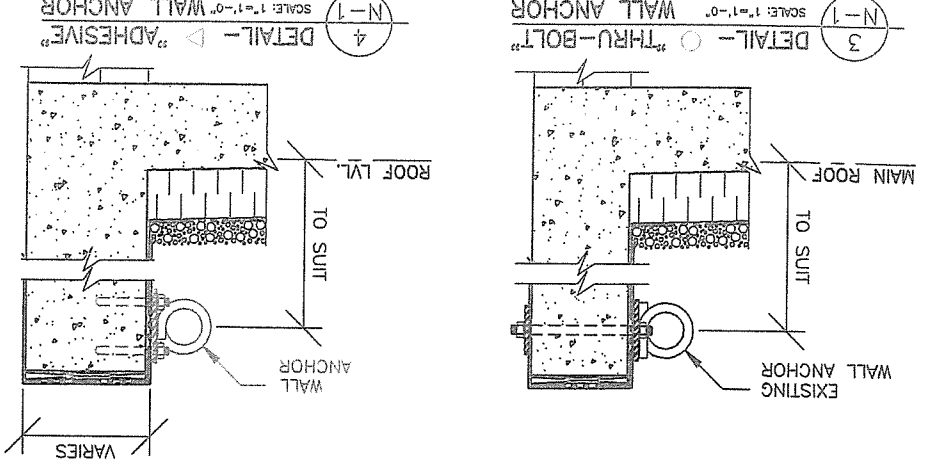
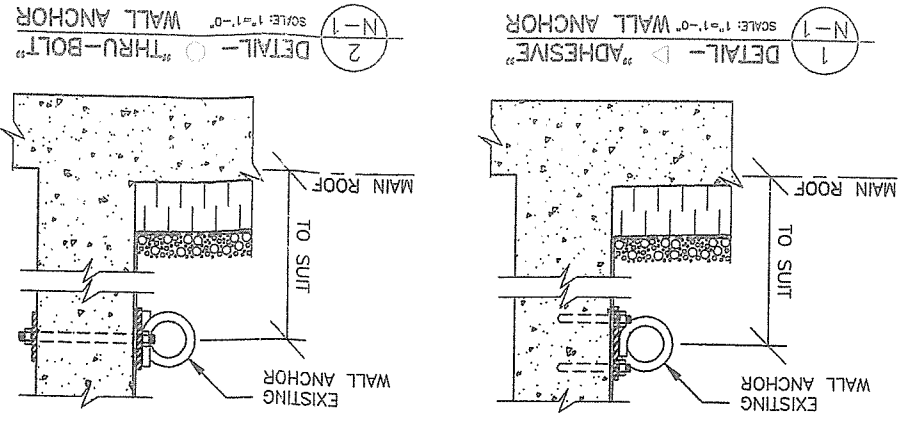
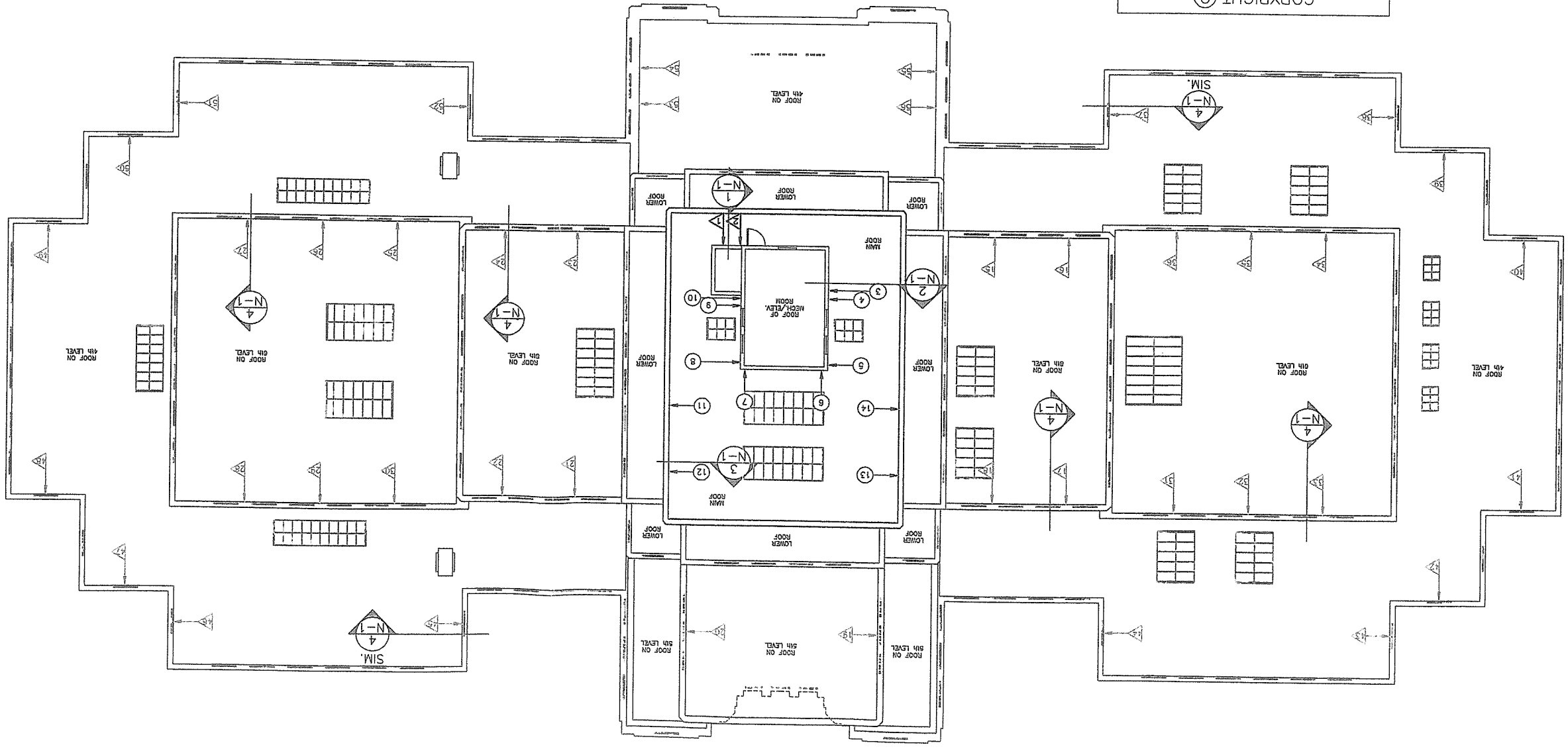

- LEGEND:
- 1. ATLAS "ADHESIVE" WALL ANCHOR LOCATIONS
 - 2. EXISTING ATLAS "ADHESIVE" WALL ANCHOR LOCATIONS (PHASE 1 INSTALLATION)
 - 3. EXISTING ATLAS "THRU-BOLT" WALL ANCHOR LOCATIONS (PHASE 1 INSTALLATION)
 - 4. WINDOW LOCATIONS

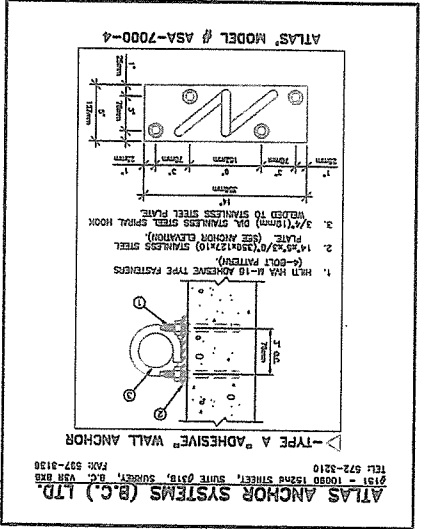
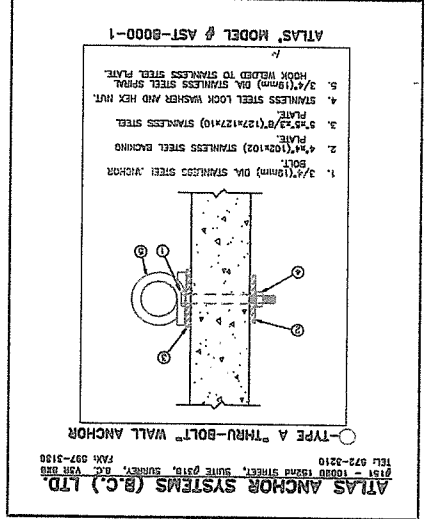

NOTE:
1. TYPICAL ANCHOR LOCATED ON VARIOUS LEVELS. REFER TO ROOF PLAN FOR LOCATIONS.

ATLAS SAFETY 'TIE-BACK' ANCHOR SYSTEM: "VANCOUVER CITY HALL", 555 WEST 12th AVENUE, VANCOUVER, BC

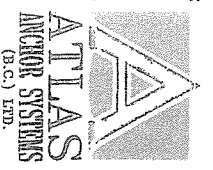

#151-10090 152 STREET,
SUITE #318
SURREY, B.C. V3R 8X8
TEL: (604) 572-3210
FAX: (604) 597-3136
EMAIL: bc@atlas-anchor.com

PREPARED FOR:
"VANCOUVER CITY HALL"
555 WEST 12th AVENUE
VANCOUVER, BC
C/O CITY OF VANCOUVER

DATE	REV.	NO.	NOTES

DATE: JULY 10, 2000
DRAWN BY: J.V.
SCALE: AS NOTED
JOB NO.: AASB0623R
SHEET NO.: N-1

APPROVED:
[Signature]
J. ROBINSON
ENGINEER

Owners List of Known Workplace Hazards

CONTRACT TITLE CITY HALL VANCOUVER DRY ICE CLEANING

PROJECT MANAGER (CITY EMPLOYEE) CHRIS SANTOS

CONTRACT NAME & # (IF KNOWN) _____

Purpose

This document shall be completed by the project manager, who shall list all the known worksite hazards and all the existing work process hazards that will be associated with the upcoming contract. The completed document shall then be provided to all potential contractors, as part of the tender package, so the project can be bid appropriately based on the known worksite hazards.

Definitions

Project Manager - the City employee designated to be the liaison with the contractor for the purpose of managing, overseeing, coordinating or in any other way administering the contract.

Instructions for Completion

The document must be completed in full. Choices for each entry are:

Y - Yes - the known worksite hazard or existing work process hazard does exist

N - No - the known worksite hazard or existing work process hazard does not exist*, or, a third party (environmental consultant) will address the issue (usually for a hazardous materials assessment)

*based on reasonable estimation from all input by persons with expertise or relevant knowledge and understanding

NA - Not Applicable - the worksite hazard or existing work process is not applicable for this contract type

Information from Hazardous Materials Assessments Provided by a Third Party

A hazardous materials assessment may be completed prior to the Project Manager completing the Owners List of Known Workplace Hazards. Any such assessment should be referenced by the Project Manager in this document and provided with the tender package. Hazardous materials may include asbestos, lead, crystalline silica, ammonia, PCB's, CFC's, moulds, mercury, ozone depleting substances (ODS), radioactive substances.

Assistance in Completing this Document

If you have questions while completing this document, or are unsure if the listed hazards apply, please seek assistance from Health and Safety (604.871.6078 or healthandsafety@vancouver.ca).

HAZARD OR ISSUE	Project Manager
1. ASBESTOS-CONTAINING MATERIALS - disturbance or penetrations of flooring, walls, ceiling tiles, pipe lagging, ac pipe, transite siding, particularly in older facilities; e.g., furniture/fixture installation, carpeting/flooring services, and boiler repair/tune-up services.	Yes No N/A
a) Asbestos containing materials (ACM) will be encountered	<input type="checkbox"/> <input checked="" type="checkbox"/> <input type="checkbox"/>
b) A hazardous materials assessment for asbestos is provided in the tender package	<input type="checkbox"/> <input checked="" type="checkbox"/> <input type="checkbox"/>
c) A hazardous materials assessment for asbestos is the responsibility of the contractor	<input type="checkbox"/> <input checked="" type="checkbox"/> <input type="checkbox"/>

2. LEAD-CONTAINING MATERIALS - disturbance of lead-based paint, particularly in older facilities. Also present in certain electrical circuitry and metal alloys; .e.g., overhead bridge crane maintenance/repair, high-voltage cable splicing services, boiler repair/tune-up services, fixture installation services, and chiller maintenance/repair services.	Yes No N/A
a) Inorganic lead-containing materials may be encountered	<input type="checkbox"/> <input checked="" type="checkbox"/> <input type="checkbox"/>
b) A hazardous materials assessment for lead is provided in the tender package	<input type="checkbox"/> <input checked="" type="checkbox"/> <input type="checkbox"/>
c) A hazardous materials assessment for lead is the responsibility of the contractor	<input type="checkbox"/> <input checked="" type="checkbox"/> <input type="checkbox"/>

3. OTHER HAZARDOUS MATERIALS - may include ammonia, pcb's, cfc's, moulds, mercury, ozone depleting substances (ods), radioactive substances, sewage, unknown contaminated materials, other: (list other here)_____	Yes No N/A
a) A hazardous materials assessment for ammonia is provided in the tender package	<input type="checkbox"/> <input type="checkbox"/> <input checked="" type="checkbox"/>
b) A hazardous materials assessment for (list the specific hazardous material) will be provided in the tender package	<input type="checkbox"/> <input type="checkbox"/> <input checked="" type="checkbox"/>
c) A hazardous materials assessment for (list the specific hazardous materials) will be the contractors responsibility	<input type="checkbox"/> <input checked="" type="checkbox"/> <input type="checkbox"/>

4. CONFINED SPACES - working in vaults, chambers, pits, tanks, etc.; e.g., construction, inspection and testing services, water/fuel storage tank clean-out services, and utility corrosion inspection services.	Yes No N/A
a) A hazard assessment (for entry and inspection only) from the City of Vancouver is provided in the tender package	<input type="checkbox"/> <input type="checkbox"/> <input checked="" type="checkbox"/>
b) The City of Vancouver shall provide procedures to isolate adjacent piping, or to lock out equipment (complicated systems only)	<input type="checkbox"/> <input type="checkbox"/> <input checked="" type="checkbox"/>
c) The contractor shall be responsible for isolation and lockout procedures	<input type="checkbox"/> <input type="checkbox"/> <input checked="" type="checkbox"/>

HAZARD OR ISSUE	Project Manager
1. ASBESTOS-CONTAINING MATERIALS - disturbance or penetrations of flooring, walls, ceiling tiles, pipe lagging, ac pipe, transite siding, particularly in older facilities; e.g., furniture/fixture installation, carpeting/flooring services, and boiler repair/tune-up services.	Yes No N/A
a) Asbestos containing materials (ACM) will be encountered	<input type="checkbox"/> <input checked="" type="checkbox"/> <input type="checkbox"/>
b) A hazardous materials assessment for asbestos is provided in the tender package	<input type="checkbox"/> <input checked="" type="checkbox"/> <input type="checkbox"/>
c) A hazardous materials assessment for asbestos is the responsibility of the contractor	<input type="checkbox"/> <input checked="" type="checkbox"/> <input type="checkbox"/>

2. LEAD-CONTAINING MATERIALS - disturbance of lead-based paint, particularly in older facilities. Also present in certain electrical circuitry and metal alloys; .e.g., overhead bridge crane maintenance/repair, high-voltage cable splicing services, boiler repair/tune-up services, fixture installation services, and chiller maintenance/repair services.	Yes No N/A
a) Inorganic lead-containing materials may be encountered	<input type="checkbox"/> <input checked="" type="checkbox"/> <input type="checkbox"/>
b) A hazardous materials assessment for lead is provided in the tender package	<input type="checkbox"/> <input checked="" type="checkbox"/> <input type="checkbox"/>
c) A hazardous materials assessment for lead is the responsibility of the contractor	<input type="checkbox"/> <input checked="" type="checkbox"/> <input type="checkbox"/>

3. OTHER HAZARDOUS MATERIALS - may include ammonia, pcb's, cfc's, moulds, mercury, ozone depleting substances (ods), radioactive substances, sewage, unknown contaminated materials, other: (list other here) _____	Yes No N/A
a) A hazardous materials assessment for ammonia is provided in the tender package	<input type="checkbox"/> <input type="checkbox"/> <input checked="" type="checkbox"/>
b) A hazardous materials assessment for (list the specific hazardous material) will be provided in the tender package	<input type="checkbox"/> <input type="checkbox"/> <input checked="" type="checkbox"/>
c) A hazardous materials assessment for (list the specific hazardous materials) will be the contractors responsibility	<input type="checkbox"/> <input checked="" type="checkbox"/> <input type="checkbox"/>

4. CONFINED SPACES - working in vaults, chambers, pits, tanks, etc.; e.g., construction, inspection and testing services, water/fuel storage tank clean-out services, and utility corrosion inspection services.	Yes No N/A
a) A hazard assessment (for entry and inspection only) from the City of Vancouver is provided in the tender package	<input type="checkbox"/> <input type="checkbox"/> <input checked="" type="checkbox"/>
b) The City of Vancouver shall provide procedures to isolate adjacent piping, or to lock out equipment (complicated systems only)	<input type="checkbox"/> <input type="checkbox"/> <input checked="" type="checkbox"/>
c) The contractor shall be responsible for isolation and lockout procedures	<input type="checkbox"/> <input type="checkbox"/> <input checked="" type="checkbox"/>

5. LOCK OUT - industrial equipment maintenance, power machinery repair services, pump maintenance/repair services, mechanical refrigeration systems, elevator repair, overhead bridge crane maintenance/repair services, cathodic protection services, hydraulic test systems repair/service, and air compressor rebuilding services.	Yes No N/A
a) Lockout will be required to isolate or prevent the unexpected release of energy (electrical, mechanical, hydraulic, chemical, thermal, kinetic, gravitational, pneumatic)	<input type="checkbox"/> <input type="checkbox"/> <input checked="" type="checkbox"/>
b) Work will be performed on or near energized equipment, lines, or circuits	<input type="checkbox"/> <input type="checkbox"/> <input checked="" type="checkbox"/>

If yes to a) or b) describe:

6. FALL PROTECTION - tree pruning, window and ledge cleaning, window replacement, overhead bridge crane maintenance/repair services, roll-up door replacement, tent installation, awning/canopy installation, overhead air exchange installation, construction inspection and testing services.	Yes No N/A
a) Workers will be exposed to a potential fall in excess of 3 m (10 feet), or to a fall of less than 3 m which would likely result in a serious injury (ex. impalement on rebar)	<input checked="" type="checkbox"/> <input type="checkbox"/> <input type="checkbox"/>
b) Scaffolding or ladders will be required to be secured to a building or structure	<input checked="" type="checkbox"/> <input type="checkbox"/> <input type="checkbox"/>

ALL EQUIPMENT WILL BE PROVIDED BY THE CONTRACTOR.
INSTALLATION AND SAFETY INSPECTION BY THE CONTRACTOR.

7. OVERHEAD AND UNDERGROUND UTILITIES - tree pruning services, tree removal, utility relocation or replacement, underground utility identification (digging with powered equipment), concrete sawing services, pole painting	Yes No N/A
a) There will be electrical hazards associated with overhead power lines such as limits of approach and contact	<input type="checkbox"/> <input checked="" type="checkbox"/> <input type="checkbox"/>
b) Necessary assurances (in writing) have (or will be) obtained by the City, through the utility company, for any work where minimum limits of approach cannot be maintained (provide documentation and review at pre job meeting with the successful contractor candidate)	<input type="checkbox"/> <input type="checkbox"/> <input checked="" type="checkbox"/>
c) Necessary assurances must be obtained (in writing) by the successful contractor, through the utility company, for any work where minimum limits of approach will not be able to be maintained	<input type="checkbox"/> <input type="checkbox"/> <input checked="" type="checkbox"/>
d) Underground or hidden utilities are located on the job site and any excavation or drilling work in proximity to an underground utility service must be undertaken in conformity with the requirements of the owner of that utility service	<input type="checkbox"/> <input type="checkbox"/> <input checked="" type="checkbox"/>

If yes to c), and the specific physical locations where minimum limits of approach will not be able to be maintained are known, how will this information be provided to the contractor?

8. CONSTRUCTION, EXCAVATION, SHORING AND DEMOLITION	Yes No N/A
a) As Prime Contractor , the City of Vancouver project manager will submit the Notice of Project	<input checked="" type="checkbox"/> <input type="checkbox"/> <input type="checkbox"/>
b) Workers will be required to enter an excavation over 1.2m (4 ft) in depth	<input type="checkbox"/> <input type="checkbox"/> <input checked="" type="checkbox"/>

9. CHEMICALS, SOLVENTS, FUMES, VAPORS, AND/OR DUSTS (existing work processes or known worksite hazard only) - ice rinks, swimming pools, cleaning solvents, adhesives, paints, coatings, binders; e.g., storage tank clean-out services, countertop installation (epoxies), and flooring	Yes No N/A
a) The worksite has chemicals solvents, fumes, vapors or <u>dusts</u> that may affect the contractor <i>* ALGAE BUILDUP</i>	<input checked="" type="checkbox"/> <input type="checkbox"/> <input type="checkbox"/>
b) Material Safety Data Sheets for chemicals currently in use at the worksite will be available, on request, to the contractor	<input type="checkbox"/> <input type="checkbox"/> <input checked="" type="checkbox"/>

If yes to a), list the work processes and/or chemicals in use:

CONTRACTOR WILL PROVIDE MSDS FOR CHEMICAL USE.

10. NOISE - (existing work processes only)	Yes No N/A
a) Employees will be exposed to noise levels above 85dba	<input checked="" type="checkbox"/> <input type="checkbox"/> <input type="checkbox"/>

OTHER HAZARDS (NOT IDENTIFIED ABOVE)
a) <u>WEATHER</u>
b) <u>VEHICULAR TRAFFIC</u>
c)

KNOWN WORKPLACE HAZARDS LIST COMPLETED BY	
Project Manager Name (print): <u>CHRIS SANTOS</u>	
Project Manager Signature: <u>[Signature]</u>	Date: <u>JULY 29, 2018</u>
Title: <u>BSS2</u>	Phone: <u>604 968 3708</u>

8. CONSTRUCTION, EXCAVATION, SHORING AND DEMOLITION	Yes	No	N/A
a) As Prime Contractor, the City of Vancouver project manager will submit the Notice of Project	<input type="checkbox"/>	<input checked="" type="checkbox"/>	<input type="checkbox"/>
b) Workers will be required to enter an excavation over 1.2m (4 ft) in depth	<input type="checkbox"/>	<input checked="" type="checkbox"/>	<input type="checkbox"/>

9. CHEMICALS, SOLVENTS, FUMES, VAPORS, AND/OR DUSTS (existing work processes or known worksite hazard only) - ice rinks, swimming pools, cleaning solvents, adhesives, paints, coatings, binders; e.g., storage tank clean-out services, countertop installation (epoxies), and flooring	Yes	No	N/A
a) The worksite has chemicals solvents, fumes, vapors or <u>dusts</u> that may affect the contractor * <u>ALGAE BUILD-UP.</u>	<input checked="" type="checkbox"/>	<input type="checkbox"/>	<input type="checkbox"/>
b) Material Safety Data Sheets for chemicals currently in use at the worksite will be available, on request, to the contractor	<input type="checkbox"/>	<input checked="" type="checkbox"/>	<input type="checkbox"/>

If yes to a), list the work processes and/or chemicals in use:

CONTRACTOR WILL PROVIDE MSDS FOR
CHEMICAL BEING USED.

10. NOISE - (existing work processes only)	Yes	No	N/A
a) Employees will be exposed to noise levels above 85dba	<input checked="" type="checkbox"/>	<input type="checkbox"/>	<input type="checkbox"/>

OTHER HAZARDS (NOT IDENTIFIED ABOVE)
a) <u>WEATHER</u>
b) <u>VEHICULAR TRAFFIC</u>
c)

KNOWN WORKPLACE HAZARDS LIST COMPLETED BY	
Project Manager Name (print): <u>CHRIS SANTOS</u>	
Project Manager Signature: <u>[Signature]</u>	Date: <u>JUNE 29, 2018</u>
Title: <u>BSS 2</u>	Phone: <u>604 968 3708</u>

