

LANE

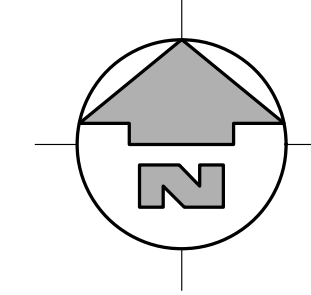

1581 WEST
4TH AVENUE

LEGAL DESCRIPTION:
LOT B
BLOCK 240
PLAN VAP11837
DISTRICT LOT 526

114'-1"

97'-5"

PROPERTY LINE

SITE PLAN
SCALE 1/8" = 1'-0"

WEST 4TH AVENUE

REVISIONS:

COV PROPERTIES
1581-1585 W. 4TH AVE.,
VANCOUVER, BC

McCUAIG & ASSOCIATES
ENGINEERING LTD.

#201 - 33 East 8th Avenue
Vancouver, BC, V5T 1R5
Phone: 604-255-0992
Fax: 604-255-1054

ONLY VALID
FOR CONSTRUCTION
WHEN SEALED AND SIGNED

SHEET TITLE:
SITE PLAN

SCALE: 1/8" = 1'-0"
DRAWN BY: GC
DRAWN ON: FEB 01, 2018
CHECKED BY: AL/PC
PROJECT #: 20171104
ISSUED FOR: 100% DESIGN ON
FEB 26, 2018

NOTE: FIELD VERIFY ALL MEASUREMENTS: DO NOT SCALE OFF DRAWINGS

A001

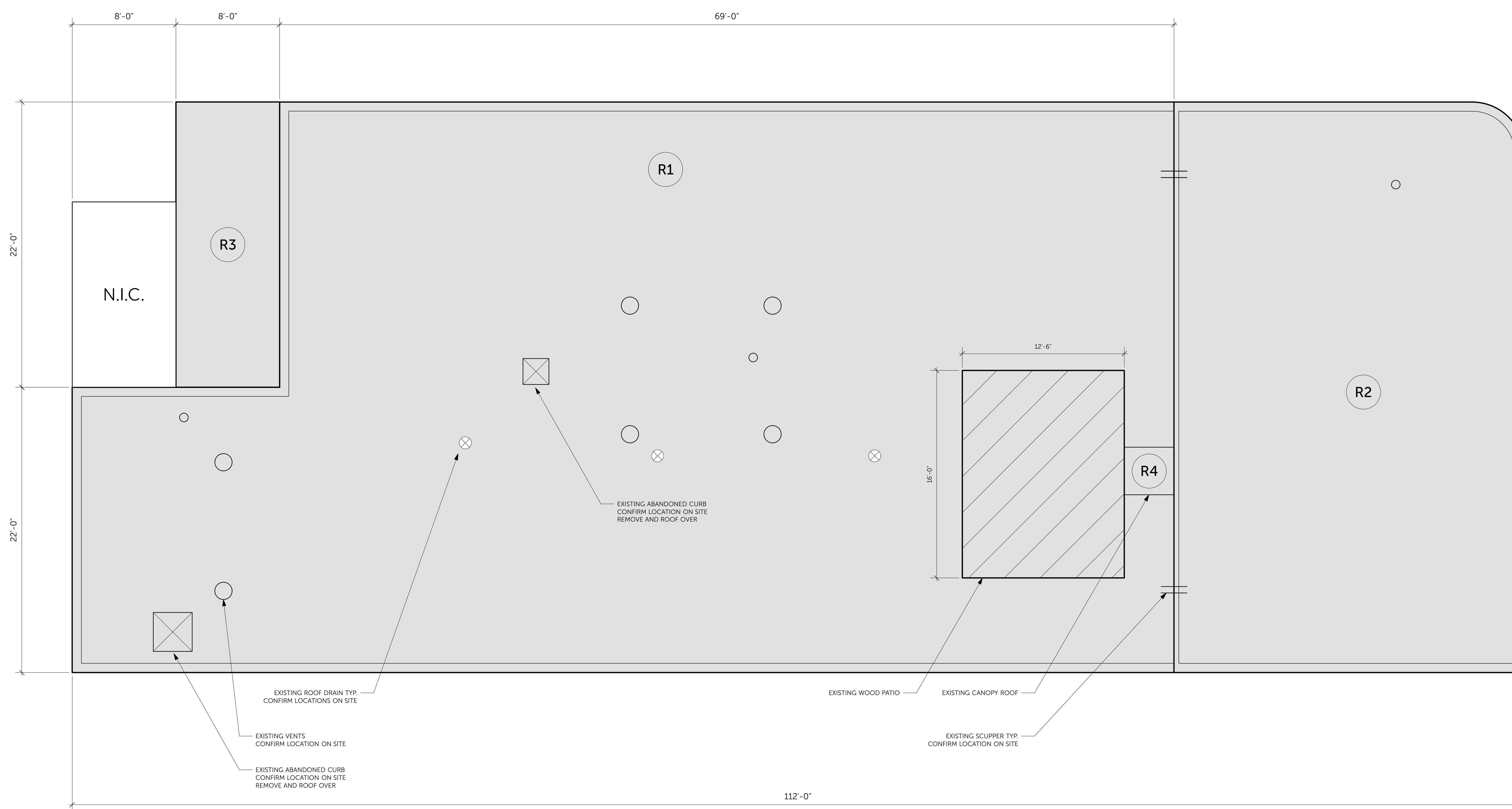
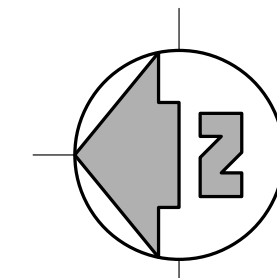

REVISIONS:

COV PROPERTIES
 1581-1585 W. 4TH AVE.,
 VANCOUVER, BC



#201 - 33 East 8th Avenue
 Vancouver, BC, V5T 1R5
 Phone: 604-255-0992
 Fax: 604-255-1054

ONLY VALID
 FOR CONSTRUCTION
 WHEN SEALED AND SIGNED

SHEET TITLE:
EXISTING ROOF PLAN

SCALE: **1/4" = 1'-0"**
 DRAWN BY: **GC**
 DRAWN ON: **DATE**
 CHECKED BY: **AL/PC**
 PROJECT #: **20171104**
 ISSUED FOR: **100% DESIGN ON
 FEB 26, 2018**

A002

EXISTING ROOF PLAN
 SCALE 1/4" = 1'-0"

- R1**
 EXISTING ROOF ASSEMBLY:
 4-PLY ASPHALT & GRAVEL ON
 2 LAYERS 1/2" FIBERBOARD ON
 1" T&G WOOD DECK
- R2**
 EXISTING ROOF ASSEMBLY:
 4-PLY ASPHALT & GRAVEL ON
 2 LAYERS 1/2" FIBERBOARD ON
 1" T&G WOOD DECK
- R3**
 EXISTING ROOF ASSEMBLY:
 4-PLY T&G ASPHALT & GRAVEL ON
 KRAFT PAPER UNDERLAY ON
 1" T&G WOOD DECK
- R4**
 EXISTING ROOF ASSEMBLY:
 GRAVEL ON
 EXISTING COLD APPLIED RUBBERIZED SYSTEM ON
 EXISTING WOOD DECKING
- R1 R2 R3 R4**
 NEW ROOF ASSEMBLY:
 SBS GRANULATED CAP SHEET ON
 SBS VENTED BASE SHEET ON
 1/2" PROTECTION BOARD ON
 NEW POLY-ISO INSULATION ON
 NEW TAPERED SLOPE PACKAGE ON
 NEW VAPOUR BARRIER ON
 1/4" MECH. FASTENED DENSEDECK ON
 EXISTING DECKING

LEGEND:

	EXISTING HATCH CURB OPENING		EXISTING DRAIN		AREA OF WORK
	EXISTING VENT		EXISTING SCUPPER		EXISTING WOOD DECK

NOTE: FIELD VERIFY ALL MEASUREMENTS: DO NOT SCALE OFF DRAWINGS

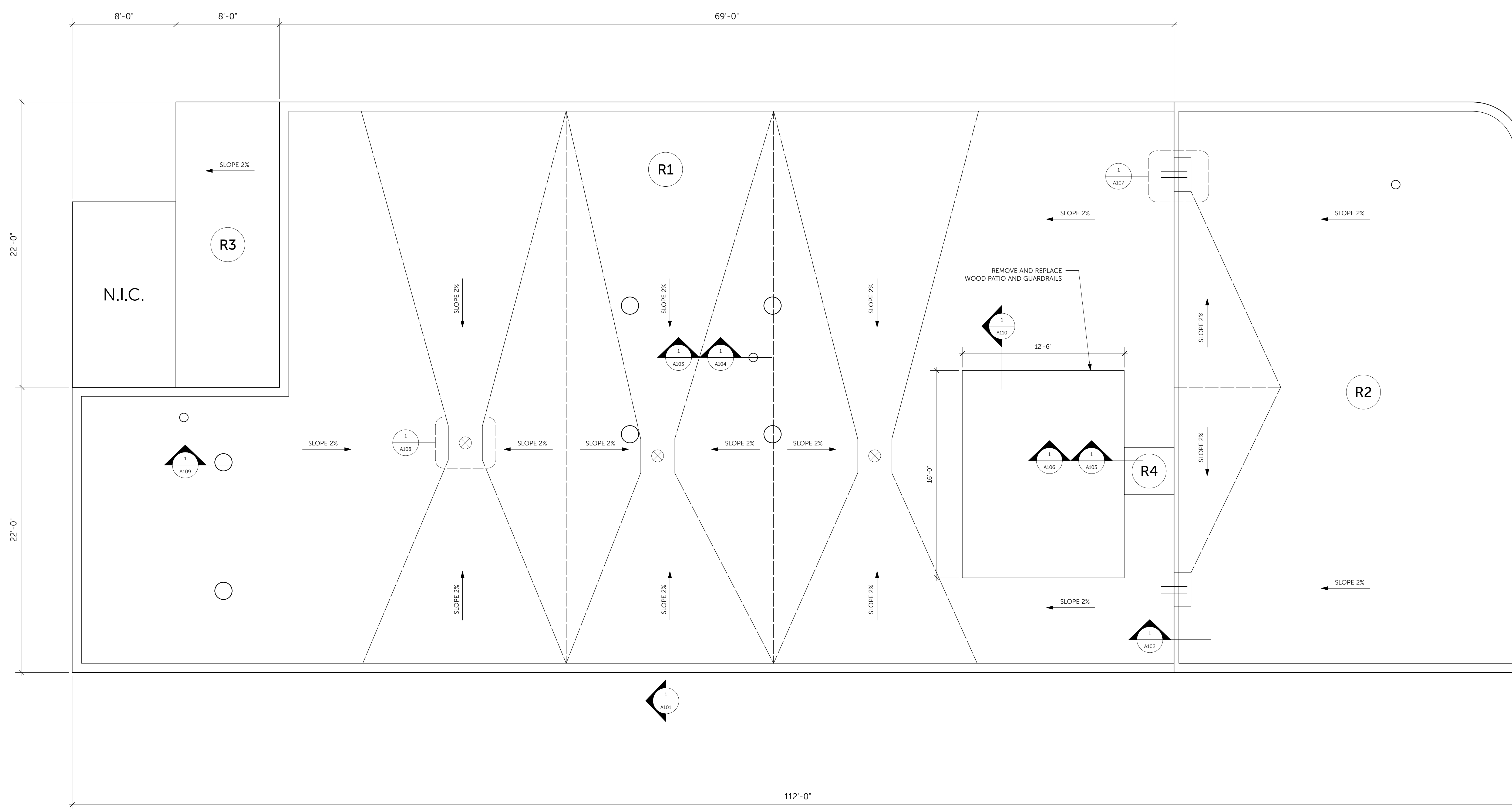
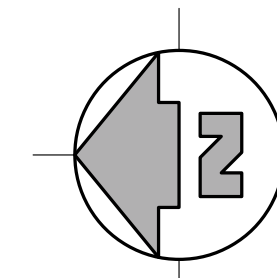

REVISIONS:

COV PROPERTIES
 1581-1585 W. 4TH AVE.,
 VANCOUVER, BC



#201 - 33 East 8th Avenue
 Vancouver, BC, V5T 1R5
 Phone: 604-255-0992
 Fax: 604-255-1054

ONLY VALID
 FOR CONSTRUCTION
 WHEN SEALED AND SIGNED

SHEET TITLE:
PROPOSED ROOF PLAN

SCALE: **1/4" = 1'-0"**
 DRAWN BY: **GC**
 DRAWN ON: **DATE**
 CHECKED BY: **AL/PC**
 PROJECT #: **20171104**
 ISSUED FOR: **100% DESIGN ON
 FEB 26, 2018**

PROPOSED ROOF PLAN
 SCALE 1/4" = 1'-0"

LEGEND:

	EXISTING HATCH CURB OPENING		EXISTING DRAIN		AREA OF WORK
	EXISTING VENT		EXISTING SCUPPER		EXISTING WOOD DECK

NOTE: FIELD VERIFY ALL MEASUREMENTS: DO NOT SCALE OFF DRAWINGS

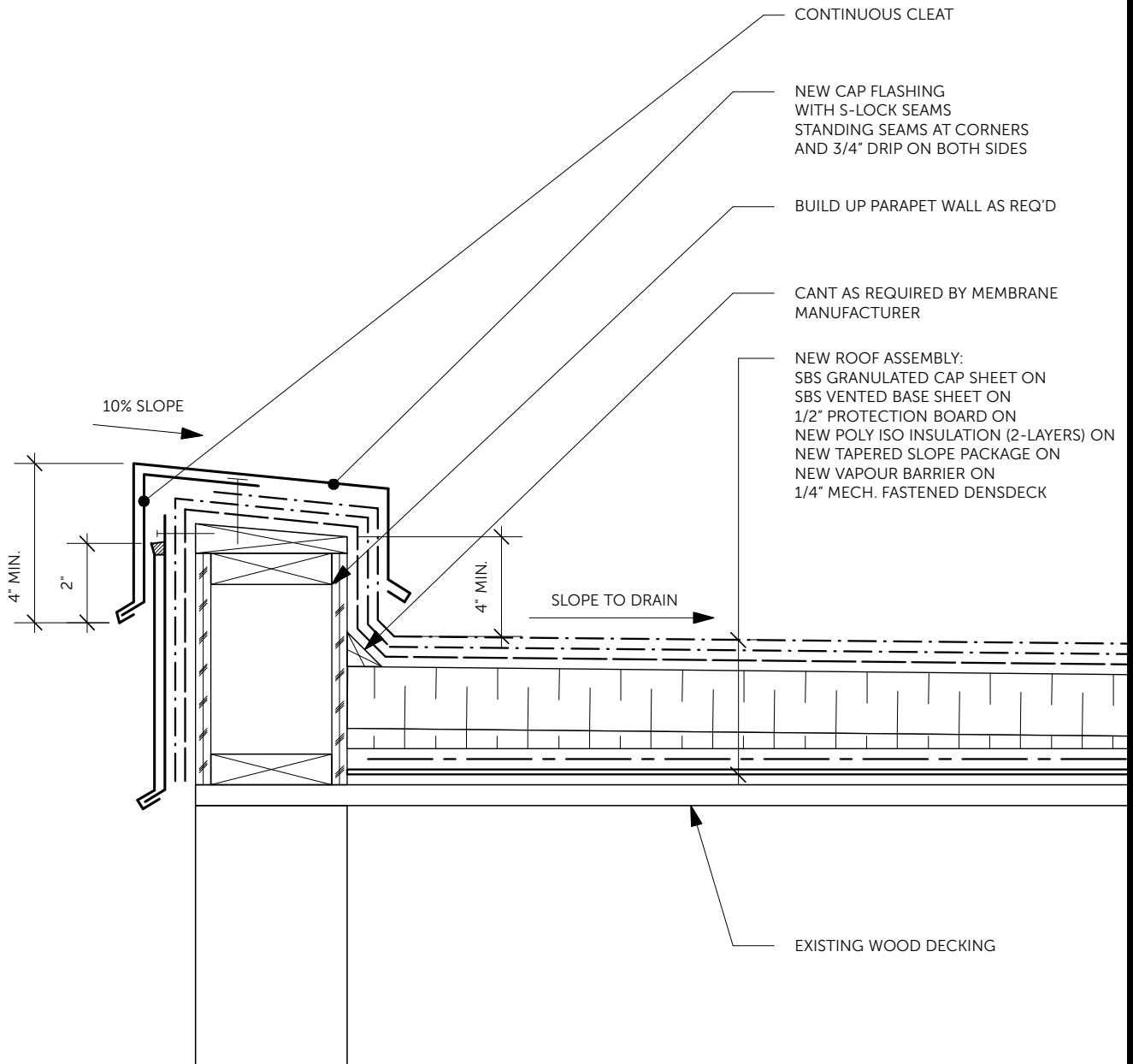

201 - 33 East 8th Avenue
Vancouver, BC, V5T 1R5
Phone: 604-255-0992
Fax: 604-255-1054

McCUAIG & ASSOCIATES
ENGINEERING LTD.

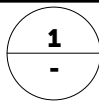

1 PARAPET WALL - SECTION

SCALE: NTS
DRAWN BY: GC
DRAWN ON: FEB 02, 2018
CHECKED BY: AL/PC

ONLY VALID FOR
CONSTRUCTION WHEN
SEALED AND SIGNED

PROJECT: **1581-1585 WEST 4TH AVENUE,
VANCOUVER, BC**

PROJECT #: **20171104**
ISSUED FOR: **100% DESIGN ON FEB 26, 2018**

ROOF MEMBRANE REPLACEMENT

NOTE: FIELD VERIFY ALL MEASUREMENTS. DO NOT SCALE OFF DRAWINGS

A101

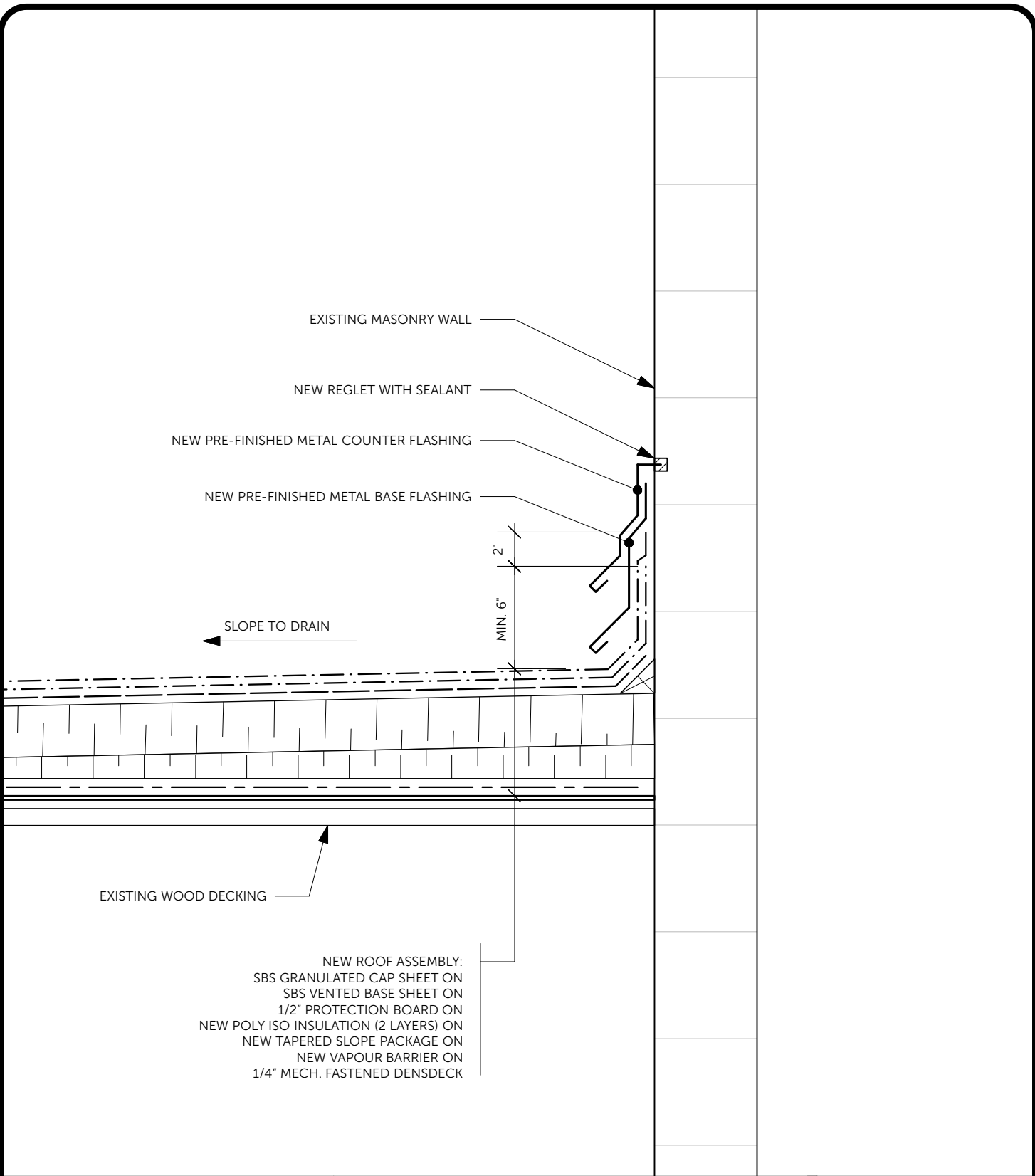

201 - 33 East 8th Avenue
 Vancouver, BC, V5T 1R5
 Phone: 604-255-0992
 Fax: 604-255-1054

McCUAIG & ASSOCIATES
 ENGINEERING LTD.

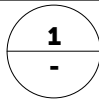

MASONRY WALL - SECTION

SCALE: **NTS**
 DRAWN BY: **GC**
 DRAWN ON: **FEB 02, 2018**
 CHECKED BY: **AL/PC**

ONLY VALID FOR
 CONSTRUCTION WHEN
 SEALED AND SIGNED

PROJECT: **1581-1585 WEST 4TH AVENUE,
 VANCOUVER, BC**

PROJECT #: **20171104**
 ISSUED FOR: **100% DESIGN ON FEB 26, 2018**

ROOF MEMBRANE REPLACEMENT

NOTE: FIELD VERIFY ALL MEASUREMENTS. DO NOT SCALE OFF DRAWINGS

A102

REINFORCED PMMA INSTALLED AS PER
MANUFACTURER'S WRITTEN INSTRUCTIONS

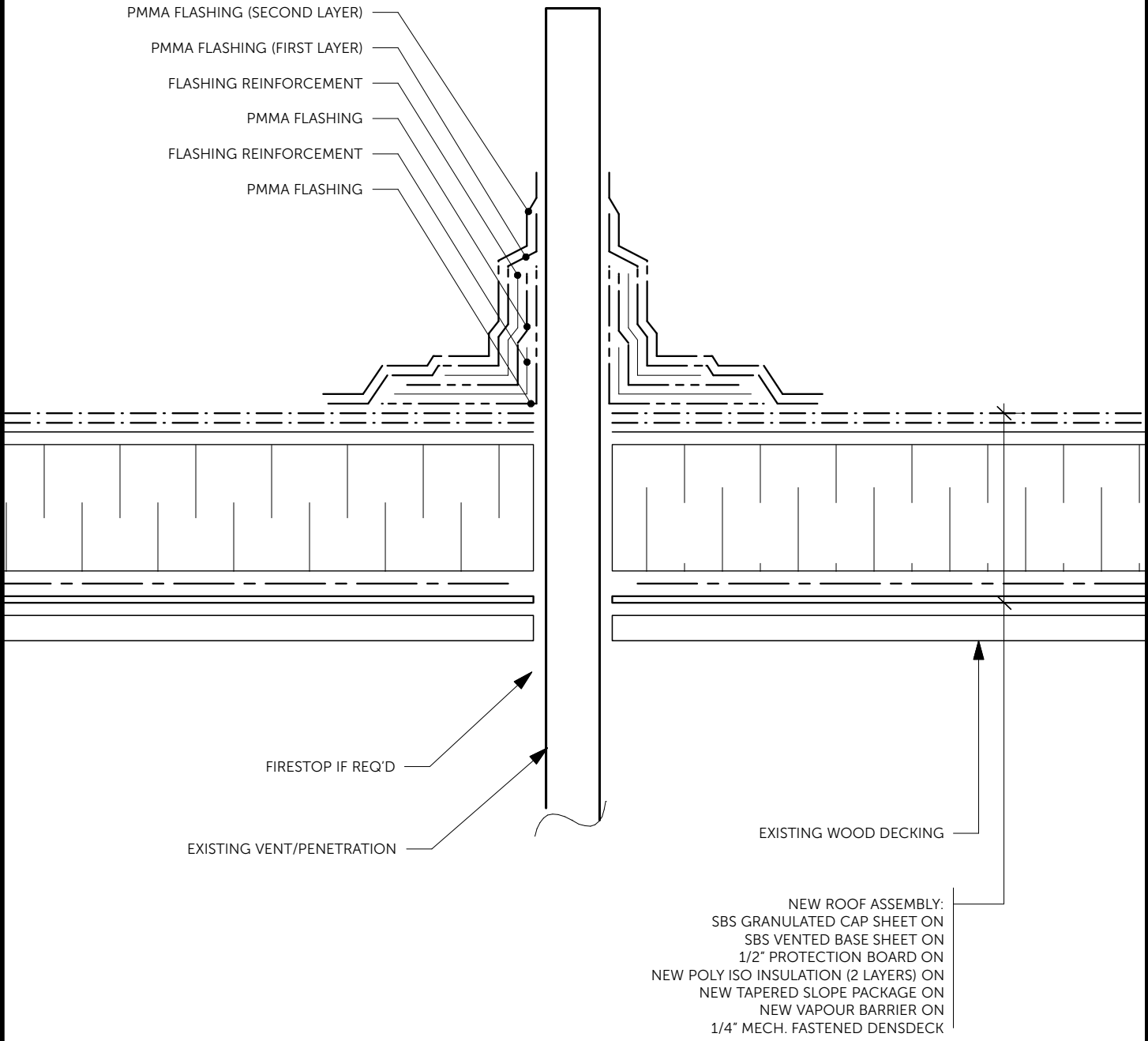

201 - 33 East 8th Avenue
Vancouver, BC, V5T 1R5
Phone: 604-255-0992
Fax: 604-255-1054

1

ROOF PENETRATION - SECTION

SCALE: **NTS**
 DRAWN BY: **GC**
 DRAWN ON: **FEB 02, 2018**
 CHECKED BY: **AL/PC**

ONLY VALID FOR
CONSTRUCTION WHEN
SEALED AND SIGNED

PROJECT: **1581-1585 WEST 4TH AVENUE,
VANCOUVER, BC**

PROJECT #: **20171104**
 ISSUED FOR: **100% DESIGN ON FEB 26, 2018**

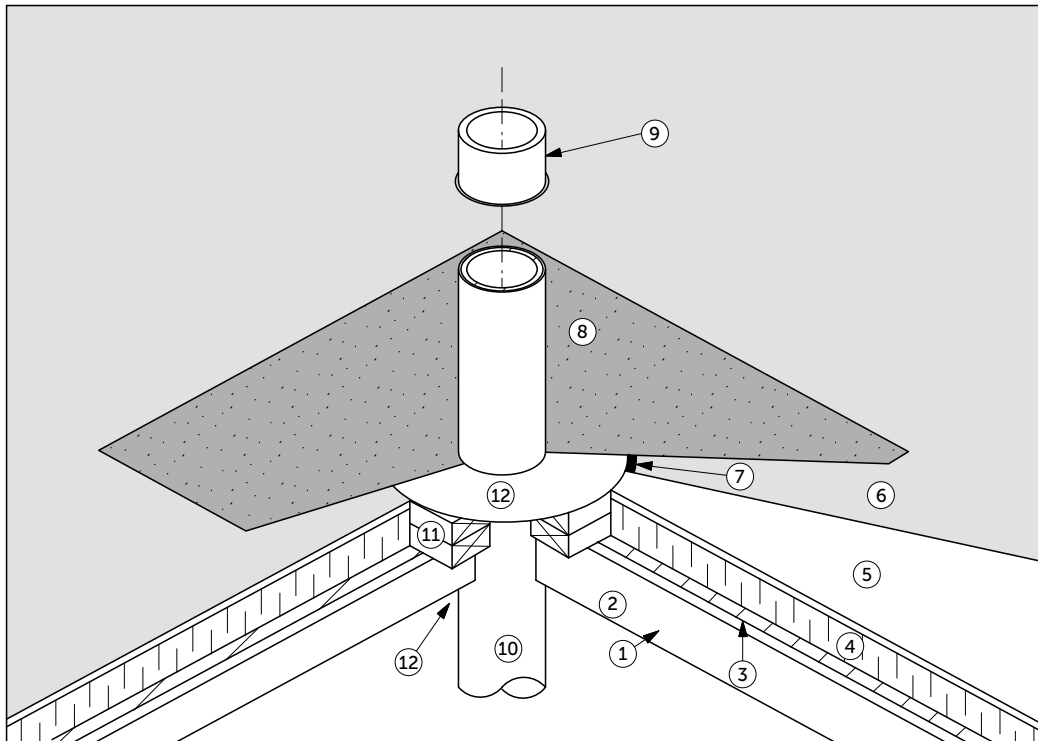

- 1 WOOD DECK
- 2 COVERBOARD
- 3 VAPOUR RETARDER
- 4 INSULATION
- 5 PROTECTION BOARD
- 6 PRIMARY MEMBRANE AND MEMBRANE PROTECTION
- 7 MASTIC
- 8 MEMBRANE FLASHING
- 9 TYPICAL LEAD CAP
- 10 PLUMBING STACK
- 11 WOOD BLOCKING
- 12 METAL FLASHING
- 13 FIRESTOP AS REQUIRED



201 - 33 East 8th Avenue
 Vancouver, BC, V5T 1R5
 Phone: 604-255-0992
 Fax: 604-255-1054

McCUAIG & ASSOCIATES
 ENGINEERING LTD.

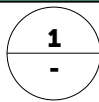

MECH/HATCH OPENING - SECTION

SCALE: **NTS**
 DRAWN BY: **GC**
 DRAWN ON: **FEB 02, 2018**
 CHECKED BY: **AL/PC**

ONLY VALID FOR
 CONSTRUCTION WHEN
 SEALED AND SIGNED

PROJECT: **1581-1585 WEST 4TH AVENUE,
 VANCOUVER, BC**

PROJECT #: **20171104**
 ISSUED FOR: **100% DESIGN ON FEB 26, 2018**

ROOF MEMBRANE REPLACEMENT

NOTE: FIELD VERIFY ALL MEASUREMENTS. DO NOT SCALE OFF DRAWINGS

A104

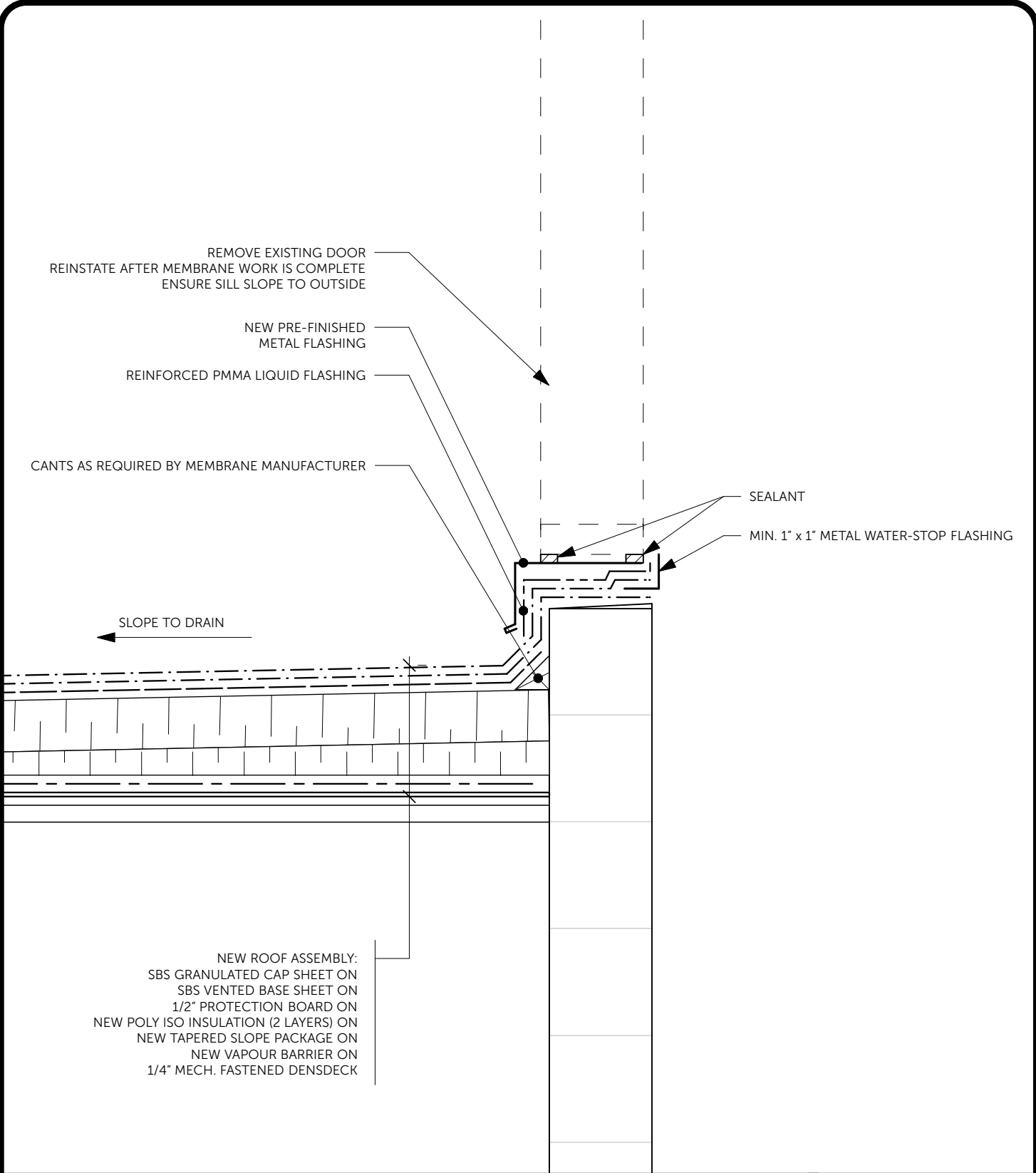

SLOPE TO DRAIN

NEW ROOF ASSEMBLY:
 SBS GRANULATED CAP SHEET ON
 SBS VENTED BASE SHEET ON
 1/2" PROTECTION BOARD ON
 NEW POLY ISO INSULATION (2 LAYERS) ON
 NEW TAPERED SLOPE PACKAGE ON
 NEW VAPOUR BARRIER ON
 1/4" MECH. FASTENED DENSDECK



201 - 33 East 8th Avenue
 Vancouver, BC, V5T 1R5
 Phone: 604-255-0992
 Fax: 604-255-1054

McCUAIG & ASSOCIATES
 ENGINEERING LTD.

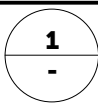

DOOR OPENING - SECTION

SCALE: **NTS**
 DRAWN BY: **GC**
 DRAWN ON: **FEB 02, 2018**
 CHECKED BY: **AL/PC**

ONLY VALID FOR
 CONSTRUCTION WHEN
 SEALED AND SIGNED

PROJECT: **1581-1585 WEST 4TH AVENUE,
 VANCOUVER, BC**

PROJECT #: **20171104**
 ISSUED FOR: **100% DESIGN ON FEB 26, 2018**

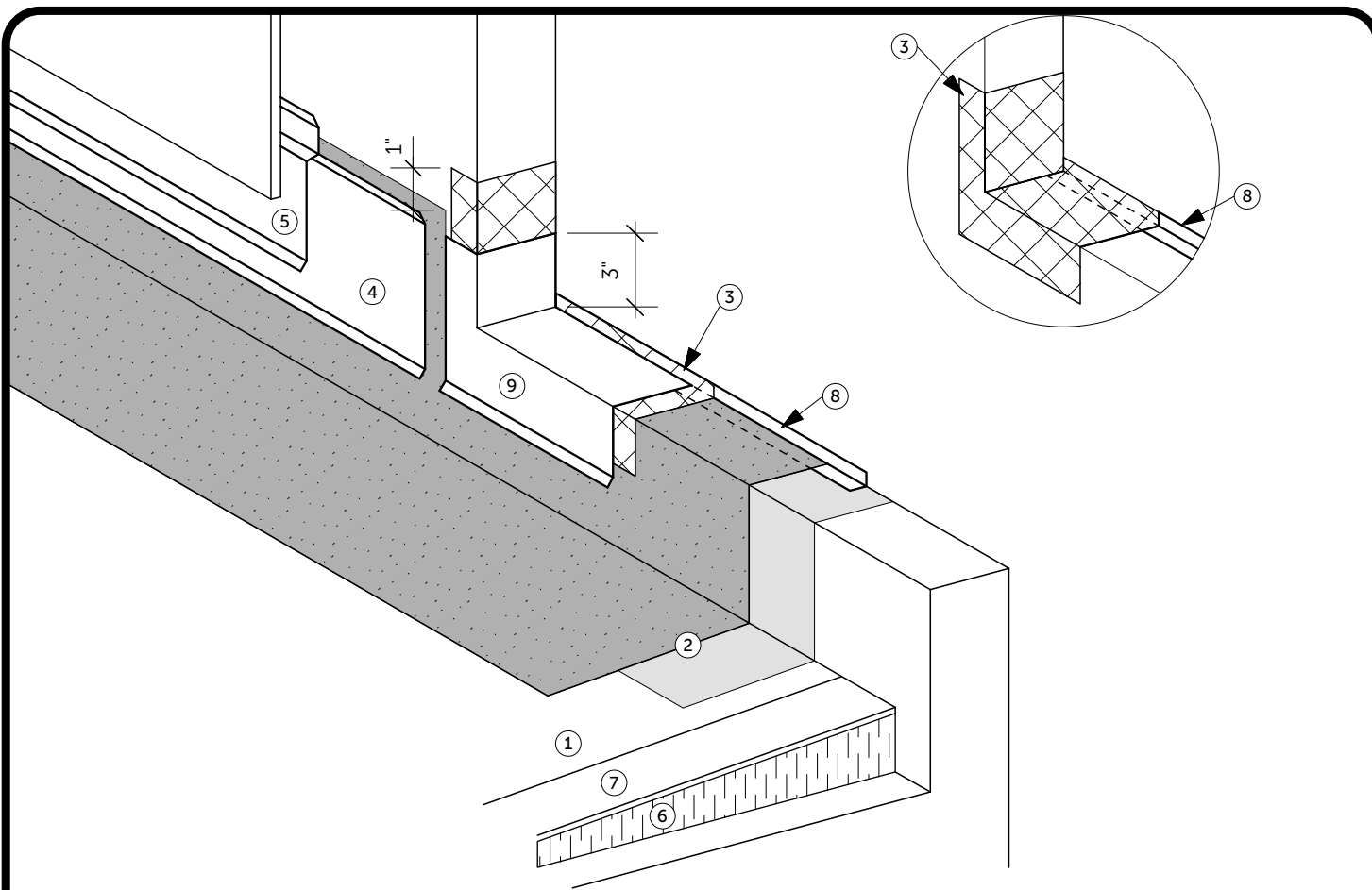

- 1 PRIMARY MEMBRANE
- 2 MEMBRANE FLASHING - LAP CAP STRIPPING OVER BASE STRIPPING AS REQUIRED BY MEMBRANE MANUFACTURER. INSTALL MEMBRANE GUSSETS AT CORNERS.
- 3 REINFORCED PMMA LIQUID FLASHING - ALONG DOOR SILL AND UP CORNERS. SEAL METAL WATER-STOP FLASHING.
- 4 METAL BASE FLASHING - TO BE CONTINUOUS WITH METAL PAN SILL FLASHING
- 5 METAL COUNTER FLASHING
- 6 INSULATION
- 7 INSULATION OVERLAY
- 8 METAL WATER-STOP FLASHING - MIN. 1" X 1" ATTACHED TO INSIDE OF DOOR SILL FRAMING CUT FLASHING TO FIT OPENING AND INSTALL MEMBRANE GUSSETS AT CORNERS. SEALED WITH MEMBRANE FLASHING.
- 9 METAL PAN SILL FLASHING - METAL PAN WITH WATER STOP FORMED WITH PAN FOLD WELDED OR SOLDERED CORNERS MECHANICALLY ATTACHED TO INSIDE OF DOOR SILL FRAME.



201 - 33 East 8th Avenue
Vancouver, BC, V5T 1R5
Phone: 604-255-0992
Fax: 604-255-1054

McCUAIG & ASSOCIATES
ENGINEERING LTD.

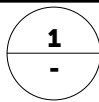

LOW DOOR SILL DETAIL

SCALE: **NTS**
DRAWN BY: **GC**
DRAWN ON: **FEB 02, 2018**
CHECKED BY: **AL/PC**

ONLY VALID FOR
CONSTRUCTION WHEN
SEALED AND SIGNED

PROJECT: **1581-1585 WEST 4TH AVENUE,
VANCOUVER, BC**

PROJECT #: **20171104**
ISSUED FOR: **100% DESIGN ON FEB 26, 2018**

ROOF MEMBRANE REPLACEMENT

NOTE: FIELD VERIFY ALL MEASUREMENTS. DO NOT SCALE OFF DRAWINGS

A106

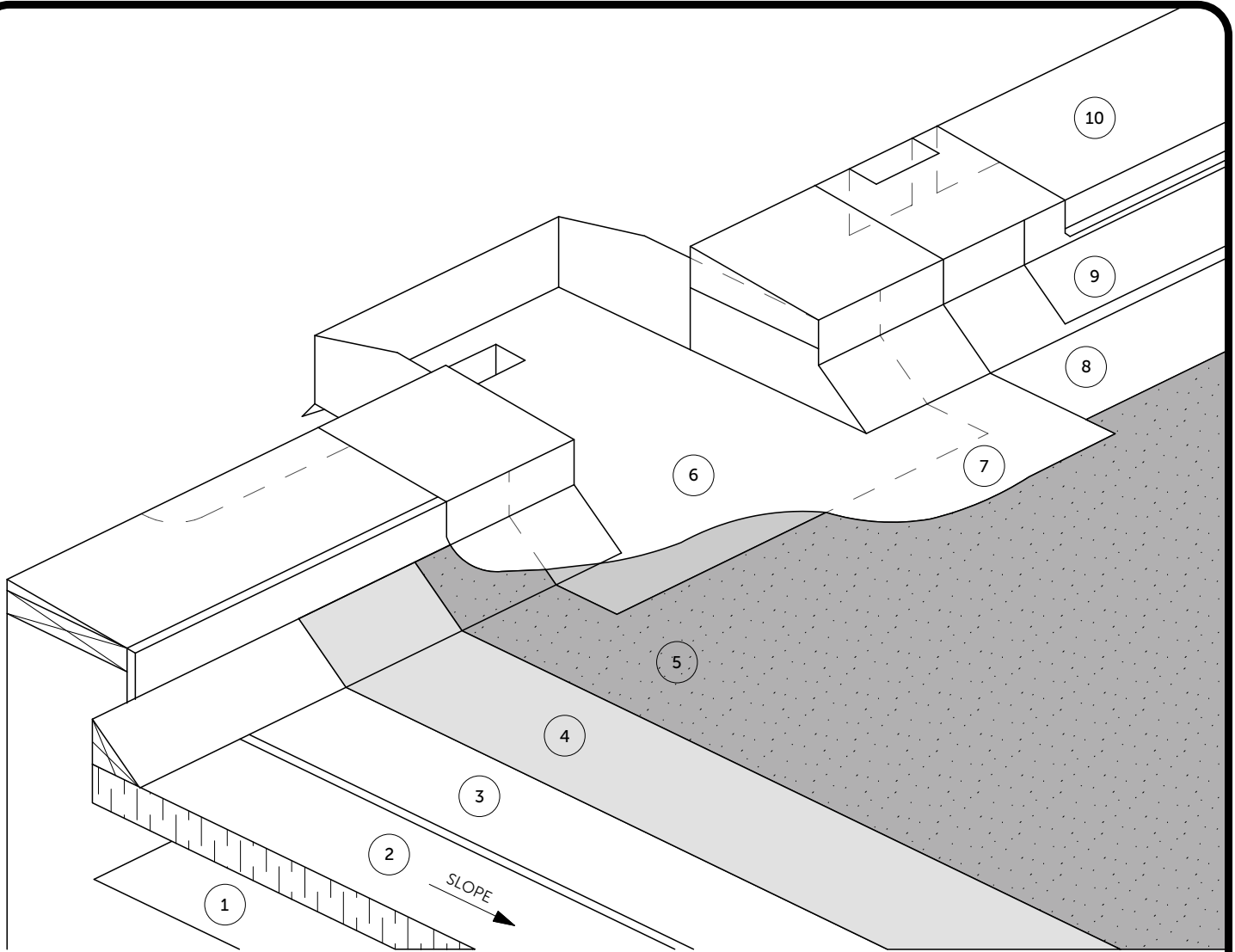

OVERFLOW SCUPPER DETAIL

WORK INCLUDED:

- 1) VAPOUR RETARDER
- 2) SLOPED INSULATION PACKAGE
- 3) INSULATION OVERLAY
- 4) BASE SHEET
- 5) CAP SHEET
- 6) METAL SCUPPER WITH HOPPER: THE OUTSIDE FACE OF SCUPPER TO BE 37.7mm (1 1/2") LOWER THAN THE BOX HEIGHT WITH A 12.7MM (1/2") DRIP EDGE. INSTALLED IN A THIN BED OF COMPATIBLE MASTIC. INTERFACE BETWEEN OUTSIDE WALL AND SCUPPER SHOULD BE CAULKED WITH APPROPRIATE SEALANT. INSTALLED WHEN WALL FINISH IS COMPLETE PRIOR TO COMPLETION OF ROOFING.
- 7) SCUPPER MEMBRANE FLASHING
- 8) MEMBRANE FLASHING
- 9) METAL BASE FLASHING: MECHANICALLY FASTENED.
- 10) METAL CAP FLASHING: FASTEN WITH CONTINUOUS CONCEALED CLIP-TYPE FASTENERS OR CLADDING SCREWS EVENLY SPACED BETWEEN SEAMS. S-LOCK SEAMS. STANDING SEAMS AT CORNERS WITH 3/4" DRIP ON BOTH SIDES. CONTINUOUS CLEAT ON OUTSIDE FACE.



201 - 33 East 8th Avenue
 Vancouver, BC, V5T 1R5
 Phone: 604-255-0992
 Fax: 604-255-1054

McCUAIG & ASSOCIATES
 ENGINEERING LTD.

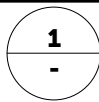

BOX SCUPPER DETAIL

SCALE: NTS
 DRAWN BY: GC
 DRAWN ON: FEB 02, 2018
 CHECKED BY: AL/PC

ONLY VALID FOR
 CONSTRUCTION WHEN
 SEALED AND SIGNED

PROJECT: 1581-1585 WEST 4TH AVENUE,
 VANCOUVER, BC

PROJECT #: 20171104
 ISSUED FOR: 100% DESIGN ON FEB 26, 2018

ROOF MEMBRANE REPLACEMENT

NOTE: FIELD VERIFY ALL MEASUREMENTS. DO NOT SCALE OFF DRAWINGS

A107

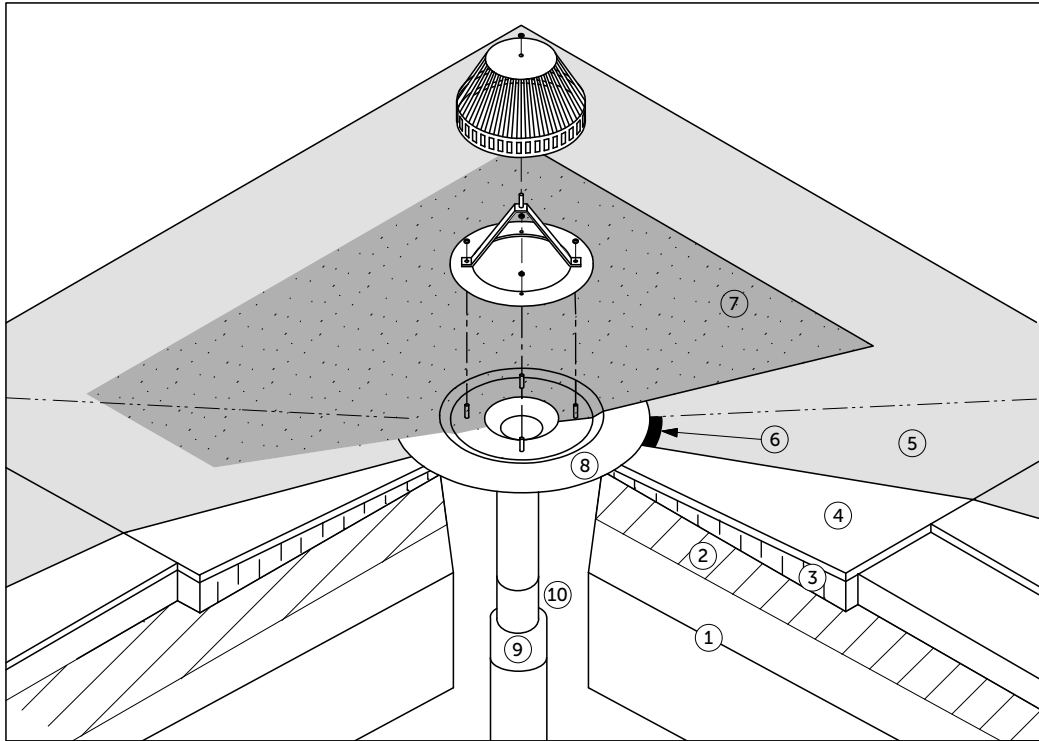

- 1 EXISTING DECK
- 2 VAPOUR BARRIER
- 3 INSULATION
- 4 INSULATION OVERLAY
- 5 PRIMARY MEMBRANE AND MEMBRANE PROTECTION
- 6 MASTIC - COMPATIBLE MASTIC ACCEPTED BY MEMBRANE MANUFACTURER
- 7 MEMBRANE FLASHING
- 8 NEW ROOF DRAIN ASSEMBLY WITH APPROVED BLUE SEAL MECHANICAL JOINT
- 9 MENZIE BLUE SEAL OR APPROVED EQUIVALENT
- 10 FIRE STOP AS REQUIRED



201 - 33 East 8th Avenue
 Vancouver, BC, V5T 1R5
 Phone: 604-255-0992
 Fax: 604-255-1054

McCUAIG & ASSOCIATES
 ENGINEERING LTD.

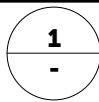

DRAIN DETAIL

SCALE: **NTS**
 DRAWN BY: **GC**
 DRAWN ON: FEB 02, 2018
 CHECKED BY: **AL/PC**

ONLY VALID FOR
 CONSTRUCTION WHEN
 SEALED AND SIGNED

PROJECT: **1581-1585 WEST 4TH AVENUE,
 VANCOUVER, BC**

PROJECT #: **20171104**
 ISSUED FOR: **100% DESIGN ON FEB 26, 2018**

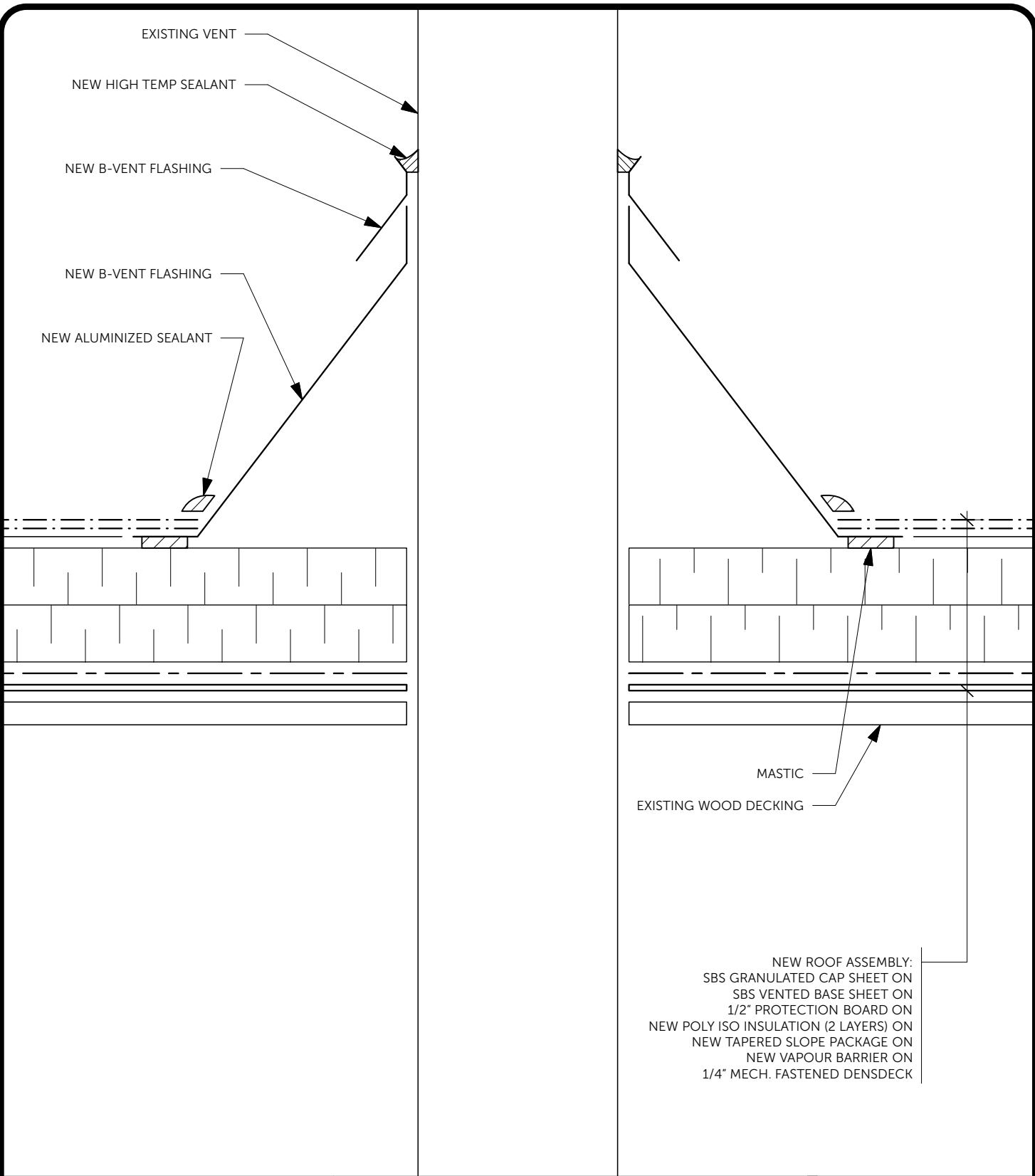

201 - 33 East 8th Avenue
 Vancouver, BC, V5T 1R5
 Phone: 604-255-0992
 Fax: 604-255-1054

McCUAIG & ASSOCIATES
 ENGINEERING LTD.

1
 -

B-VENT - SECTION

SCALE: **NTS**
 DRAWN BY: **GC**
 DRAWN ON: **FEB 26, 2018**
 CHECKED BY: **AL/PC**

ONLY VALID FOR
 CONSTRUCTION WHEN
 SEALED AND SIGNED

PROJECT: **1581-1585 WEST 4TH AVENUE,
 VANCOUVER, BC**

PROJECT #: **20171104**
 ISSUED FOR: **100% DESIGN ON FEB 26, 2018**

ROOF MEMBRANE REPLACEMENT

NOTE: FIELD VERIFY ALL MEASUREMENTS. DO NOT SCALE OFF DRAWINGS

A109

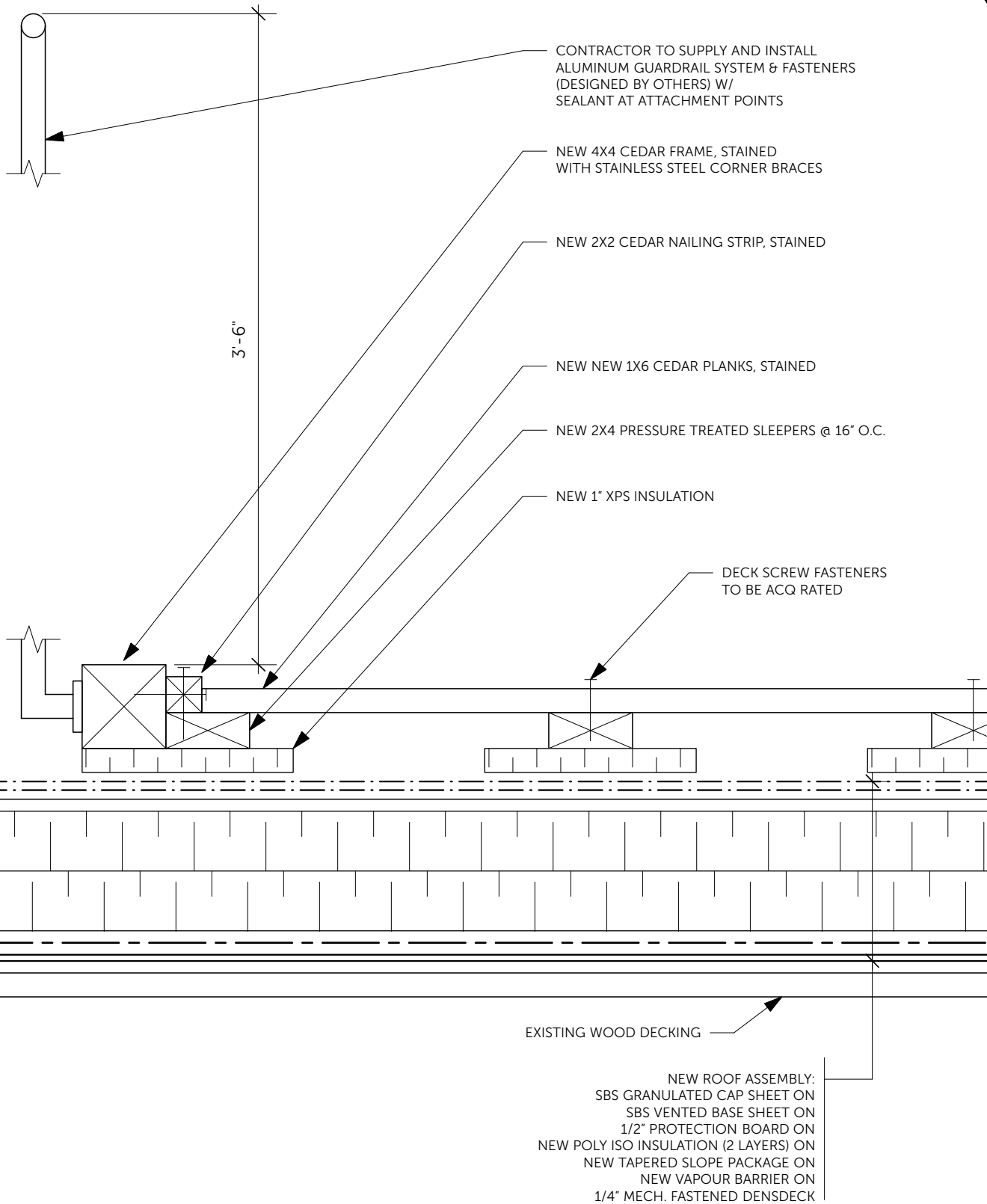

201 - 33 East 8th Avenue
 Vancouver, BC, V5T 1R5
 Phone: 604-255-0992
 Fax: 604-255-1054

McCUAIG & ASSOCIATES
 ENGINEERING LTD.

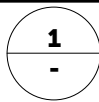

PATIO DECK -SECTION

SCALE: **NTS**
 DRAWN BY: **GC**
 DRAWN ON: **FEB 26, 2018**
 CHECKED BY: **AL/PC**

**ONLY VALID FOR
 CONSTRUCTION WHEN
 SEALED AND SIGNED**

PROJECT: **1581-1585 WEST 4TH AVENUE,
 VANCOUVER, BC**

PROJECT #: **20171104**
 ISSUED FOR: **100% DESIGN ON FEB 26, 2018**

ROOF MEMBRANE REPLACEMENT

NOTE: FIELD VERIFY ALL MEASUREMENTS. DO NOT SCALE OFF DRAWINGS

A110